

EASY START GUIDE

Thank-you for your purchase!

You've made a smart decision. Please follow these **4 QUICK STEPS** shown below to get you started.

1

ACTIVATE YOUR DEVICE

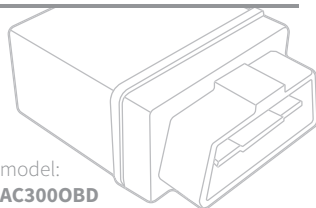

1. Visit our website and click on the "Activate" tab, and fill out the form
2. Ensure you have the Serial# for your device. (This is a device ID found on the device, or your invoice)
3. Choose the right plan for your needs
4. Activate and take control of your vehicle. (Your device activation may take up to 24 business hours)

1 855 238.3830

autoconnectgps.com

ON ALL THREE MAJOR PLATFORMS



2

INSTALL YOUR EASY PLUG AND PLAY GPS MODEM AS SOON AS POSSIBLE

Simply plug the device directly into the factory on-board diagnostic (OBDII) port.

- Port is standard in all light to mid-duty vehicles manufactured after 1996.
- Actual location will vary by vehicle year, make and model.
- Port is within 3 feet of the steering column and most likely underneath the dash panel.
- Port may be behind a cover panel (panel should open without the use of tools).

Refer to the images below for approximate OBDII port location.

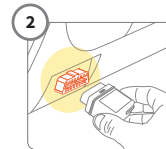
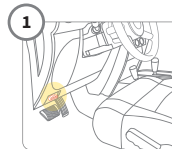

3

LOGIN TO THE AUTOCONNECT GPS MAPPING DASHBOARD OR MOBILE APP

Click on the **Customer Log-in** icon  at the top of any page of the autoconnectgps.com website or download the free App for your mobile device.

New accounts: Use the Serial# for USERNAME and PASSWORD. **Serial# is case sensitive.**

Existing accounts: Continue to use your current username and password.



4

START TRACKING YOUR VEHICLES LIKE NEVER BEFORE!

- Watch them Update Live on Google Maps
- Monitor Vehicles for Aggressive Driving and Excessive Idling
- Replay Any Trip From Start to Finish for Any Period of Time
- Automate Vehicle Diagnostic Detection Service & Maintenance
- Extensive Reporting that turns Driving Data into Fleet Intelligence

TIP

Tip: Bookmark the Login Page for Easy Access